

# 11.78 acres

Site 25B

Site 25C  
11.78 acres

AutoZone

Stony Creek Road

Cargill Cocoa and Chocolate

PPL Substation

North Park Drive

Site 17

Site 10

PPL Region of West

### ***Industrial Site ideal for Manufacturing and Distribution/Logistics***



**Greater Hazleton**  
**CANTPO**

For more information, contact CAN DO  
One South Church Street, Suite 200  
Hazleton, PA 18201  
(570) 455-1508 | (570) 454-7787 fax  
[www.hazletoncando.com](http://www.hazletoncando.com)

## SITE DETAILS

Owner:	CAN DO		
Prior use:	Undeveloped		
Zoning:	Industrial		
Site acreage:	11.78 acres		
Address:	Stony Creek Road Hazle Township, PA 18202		
Utilities:	All utilities are to the property boundary.		
	Water:	CAN DO, Inc.	
	Sewer:	CAN DO, Inc.	
		Greater Hazleton Joint Sewer Authority	
	Electric:	PPL Electric Utilities	
	Natural Gas:	UGI Utilities	
Site description:	Owner is pursuing land development approvals. Proposed plans to accommodate a 115,500 SF facility.		
Industrial neighbors:	Cargill Cocoa, AutoZone, ES Kluft & Company, Gonnella Frozen Products, PECO Pallet, Pro Con, US Cold Storage, Vita-Line Products		
Proximity to interstate:	2 Miles to Interstate 81, exit 143 via State Route 924		
Proximity to hub airport:	40 miles to Wilkes-Barre/Scranton International Airport		

## PROPOSED SITE PLAN

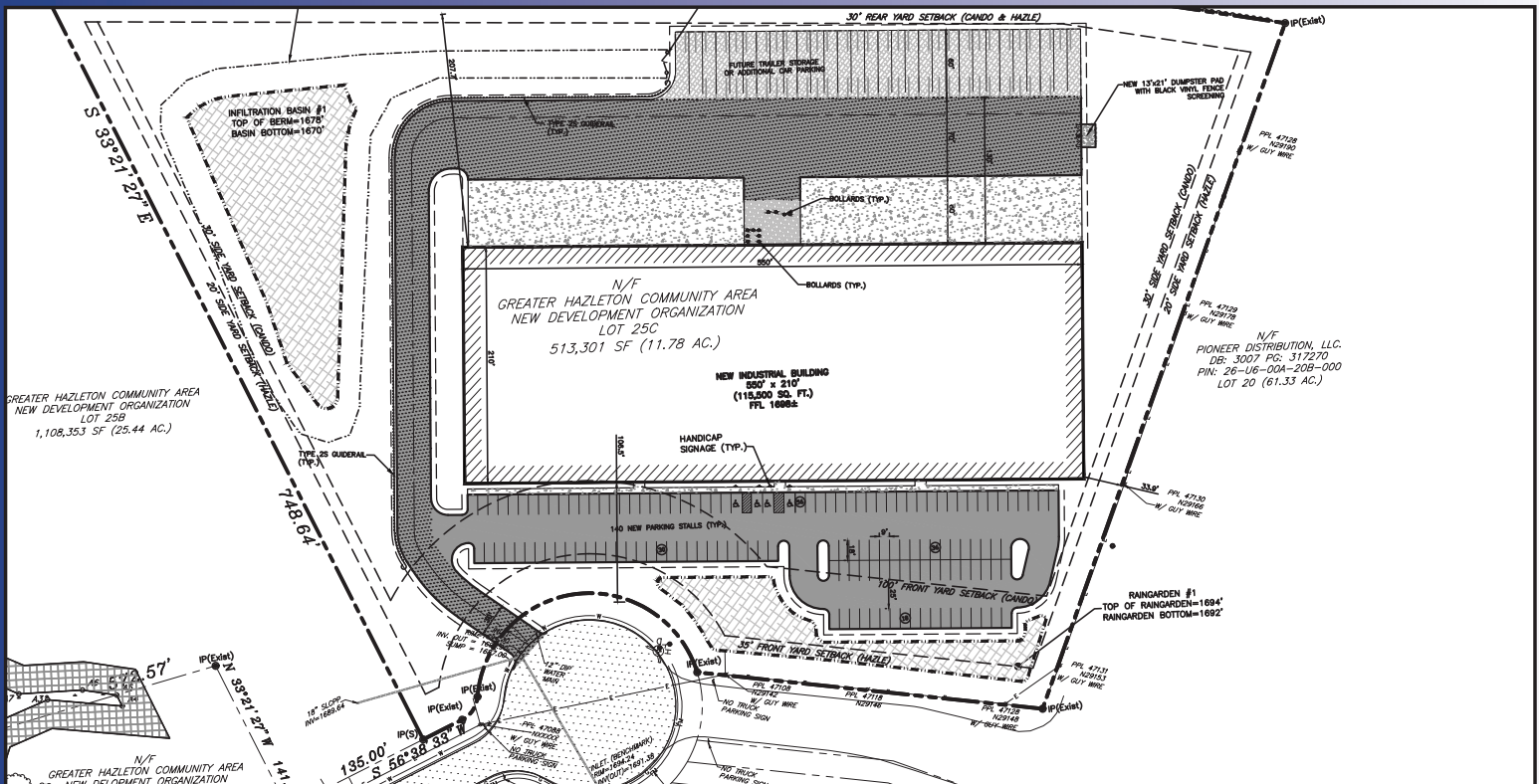

***For more information, please contact  
CAN DO  
One South Church Street, Suite 200,  
Hazleton, PA 18201***



**570-455-1508 phone**  
**570-454-7787 fax**  
**[www.hazletoncando.com](http://www.hazletoncando.com)**  
**[cando@hazletoncando.com](mailto:cando@hazletoncando.com)**